

# TRAFFIGARD

EXPOSED WATERPROOFING MEMBRANE

ASIA'S LEADING  
BUILDING PROTECTION  
SPECIALIST



# TRAFFIGARD

## EXPOSED WATERPROOFING MEMBRANE

TRAFFIGARD IS A DECORATIVE, LIQUID-APPLIED MEMBRANE OF HEAVY-BODIED ACRYLIC POLYMER GEL. IT IS REINFORCED WITH FIBERGLASS MAT DURING APPLICATION FOR MAXIMUM STRENGTH AND DURABILITY.



ITE WEST COLLEGE - SINGAPORE

## COMPOSITION

**TRAFFIGARD** roofing system consists of five primary layers.

### Primer

It fills hairline and minor cracks on the substrates, thus providing strong adhesion between substrate and membrane.

### Body coat

The heavy-bodied acrylic polymer gel which has high viscosity for building up the membrane and strengthening the system.

### Fiberglass mat

It is formed with a very tough glassfibre to increase wear and tear resistance of the membrane.

### Second body coat

Another body coat is applied immediately after the fiberglass mat layer.

### Topcoat

Topcoat is applied over the body coat for added protection against UV, abrasion, etc. and to provide an attractive finish.

TRAFFIGARD waterproofing system has gained worldwide acceptance as a superior waterproofing membrane of excellent quality and durability.

Its versatility enables it to adapt to different climate conditions worldwide.

## AREAS OF USAGE

- Flat Roof
- Pitched Roof
- Curved Roof
- All general Roof waterproofing

# DIAGRAM OVERVIEW

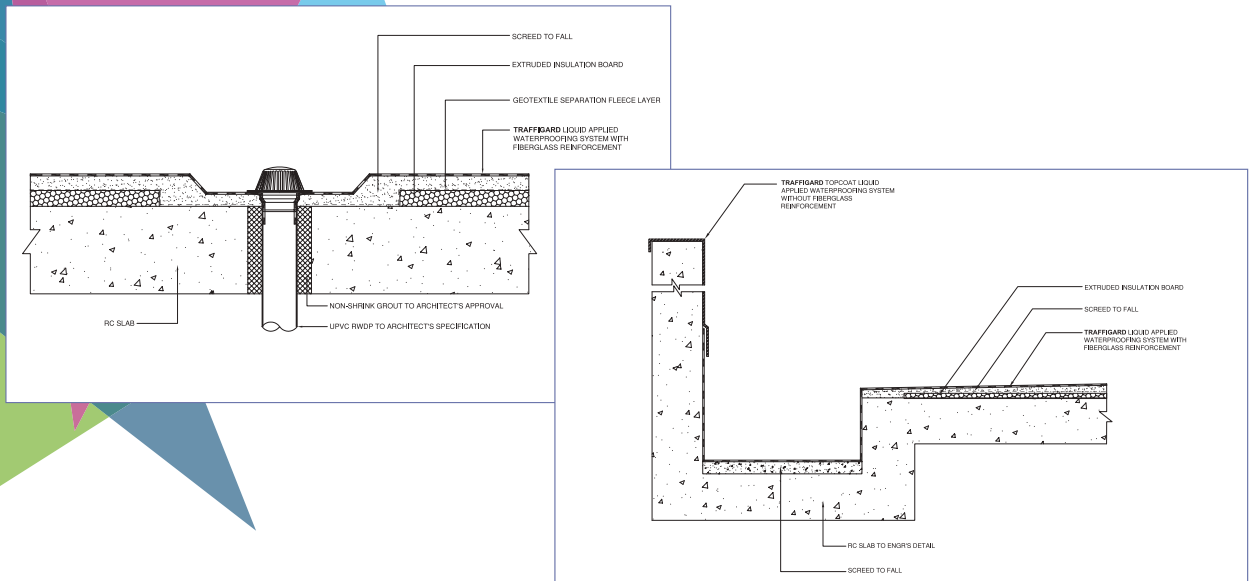

## SPECIAL FEATURES

### Durability

Reinforced with a layer of glass fiber chopped strand mat, which provides the roofing system with excellent film tensile strength and long durability.

### Flexibility

TRAFFIGARD is flexible, which enables it to bridge hairline and minor cracks.

### Trafficability

Able to withstand regular maintenance foot and light-wheeled traffic.

### Recoatability

After eight years, if another top coat is applied, its service life can be extended up to another 10 years, with the possibility of the warranty being extended.

### Chemical Resistance

Resistant to a wide range of common pollutants and diluted chemicals. The use of Formrok 335 topcoat gives additional resistance

### Beautiful Colours

Comes in a selection of colours to match the exterior finishes of buildings, which enables the roofing system to harmonize with the overall appearance of building.

### Fire Resistance

Tested to BS 476 Part 7: 1997

### Easy to Apply

Despite the five layers of application, the whole system can be applied very quickly and effectively by Hitchins trained applicators, thus saving time and labour cost.

### Cost Effective

It can be applied directly over leaking panel-roofing system without the need to remove the concrete panels.

### Easy to Maintain

Normal in-service cleaning can be carried out by mopping or low pressure washing to maintain a clean and beautiful surface. In areas where cleanliness is imperative, use dilute neutral detergent.

### WARRANTY INFORMATION

Only Hitchins' trained applicators are approved to undertake all application work. Hitchins products carry a long-term warranty for both materials and workmanship. The warranty is further backed by Hitchins International Fidelity Fund. Please check with our local applicators if this fund is available in your country. For complete warranty and other related information, please contact Hitchins regional offices.



ASIA'S LEADING  
BUILDING PROTECTION  
SPECIALIST

# TRAFFIGARD

EXPOSED WATERPROOFING MEMBRANE

## DATA SPECIFICATION SHEET



032 002  
Environmentally  
Preferred Coating



### DESCRIPTION

The **Traffigard** system is a seamless, liquid-applied, elastomeric waterproofing membrane that is available in a range of colours. The system consists of modified acrylic polymer with fibreglass reinforcement mat for better strength, build and wear resistance.

The **Traffigard** system can be easily applied onto any shapes and contours. It can be re-coated and therefore can be repaired easily in the event of puncture or damage.

### AREAS OF USAGE

The **Traffigard** System tolerates light foot traffic and is ideal for waterproofing of roofs, walk-out decks, patios, etc.

### PRODUCT SPECIFICATION

**COLOUR:** Available in a range of decorative colours

**PACKING SIZE:** 20 litre pails

**SHELF LIFE:** 2 years in unopened container

**THINNING:** The material should be used un-thinned

**DRY FILM THICKNESS:** 0.8mm-1.0mm

**ELONGATION (ASTM D412):** 579%

**TENSILE STRENGTH (ASTM D412):** 2.54Mpa

**WATER VAPOUR TRANSMISSION (ASTM E96):** 3.19g/m<sup>2</sup>.h

**ADHESION TO SUBSTRATE (ASTM D4541):** 1.13Mpa

**SHORE A HARDNESS (ASTM D2240):** 80.8

**SPREAD OF FLAME (BS 476 Part 7):** Class 3

**QUV ACCELERATED WEATHERING FOR 2000/ 3000 HOURS (ASTM G53):** Passed

**IMPACT RESISTANCE OF COATINGS (ASTM D2794):** 100kg.cm

**WATER PENETRATION (DIN 1048 Part 5):** No Penetration @ 1kg/cm<sup>2</sup>

## PRODUCT SPECIFICATION

**CRACK BRIDGING (ASTM C836):** No cracks

**COLOUR FASTNESS (ASTM D882):** No defects after 2000 Hours in QUV Weatherometer

## APPLICATION

### PRIMING:

Apply primer to the entire prepared surface either by brush or roller. The standard primer used for this system is Traffigard Primer-C or W. In some cases, the primer used may be different depending on the type of substrates as stated below. Spreading rates and drying/re-coating times are indicative only and depend on the type and condition of the substrate, temperature and humidity, etc.

Normal concrete and plaster: Traffigard Primer-W, applied at coverage of 5 m<sup>2</sup>/litre and re-coating time is 3 hours.

Dense or powdery concrete and plaster: Traffigard Primer-C applied at a coverage of 5m<sup>2</sup>/litre, and re-coating time is 3 hours.

### BODYCOAT AND REINFORCEMENT:

Apply Traffigard Bodycoat by roller at 2.5 m<sup>2</sup>/litre and immediately roll in the fibreglass mat. Apply a second coat of Traffigard Bodycoat at 2.5 m<sup>2</sup>/litre and allow to dry for about 12 hours before topcoating.

### TOPCOAT:

Apply by roller Traffigard Topcoat at 1.5 m<sup>2</sup>/litre and allow to dry for at least 24 hours before allowing light foot traffic.

### PONDING:

Ponding test can be carried out 7 days after application of the topcoat.

## HEALTH & SAFETY

Traffigard is not classified as dangerous. Dry paint can be removed from skin by using warm water and soap.

Hitchins (FE) Marketing Pte Ltd  
Telephone: (65) 6861 1177  
Facsimile: (65) 6863 4240  
Email: [hitchins@hitchins.com](mailto:hitchins@hitchins.com)

Place Product  
Sample Here

Revision D - Dec 2021

All data given and statements and recommendations made herein are based upon our research and experience and are believed to be accurate. However, no guarantee of their accuracy is made or applied. This data specification supersedes all other issues.



# MAJOR PROJECTS



Bank Of China - Singapore



The Star Vista - Singapore



Republic Plaza - Singapore



Nutrifood - Indonesia



Hazrat Shahjalal International Airport, Bangladesh



NET Group of Buildings - Philippines



Central Pinklao - Bangkok Thailand



All Fresh - Jarkarta, Indonesia



Prima Building - Colombo, Sri Lanka

# APPLICATION & INSTALLATION



1. Application of Primer



2. Leave primed surface to dry



3. Application of 1st Bodycoat



4. Unroll fiberglass over 1st bodycoat



5. Immediately apply 2nd bodycoat.



6. Apply Traffigard topcoat