



**Hitchins**  
since 1932

# NURAPLAN

PVC WATERPROOFING MEMBRANE FOR ROOFS

**ASIA'S** LEADING  
BUILDING PROTECTION  
SPECIALIST





# NURAPLAN

## PVC WATERPROOFING MEMBRANE FOR ROOFS

NURAPLAN WATERPROOFING MEMBRANES ARE PVC BASED MATERIALS, SPECIALLY FORMULATED TO WATERPROOF ROOFS, DECKS, PATIOS, GUTTERS, TANKS, PONDS, TUNNELS, CHANNELS AND ROOF GARDENS.



MEERA HOUSE @ SENTOSA COVE - SINGAPORE

## PRODUCT DESCRIPTION

**Nuraplan V** waterproofing membranes are superior quality homogeneous single ply polymeric PVC waterproofing membrane. The membrane consist of superior high polymer solids that offers excellent thermal and optimum physical/ mechanical properties.

**Nuraplan V** is used for waterproofing of flat or low sloped roofs and landscape gardens for both new building and roof/ deck refurbishment.

**Nuraplan V** is also available in basement grade for waterproofing of sub-structures.

**Nuraplan V** is available both unbacked or with polyester fleece backing and can be installed in either exposed or concealed application. The membrane can be installed loose laid, fully bonded to substrate or mechanically fastened.

**Nuraplan V** unbacked and polyester fleece back membranes are available in different thickness.

NURAPLAN membranes are strong, tough, lightweight and of the highest quality and can be used either exposed or concealed.

They are produced under strict, controlled factory conditions that result in a high quality product of uniform thickness.

## AREAS OF USAGE

- Roofs
- Decks
- Patios
- Gutters
- Planters
- Roof Gardens
- Basement/ Tunnels

# DIAGRAM OVERVIEW

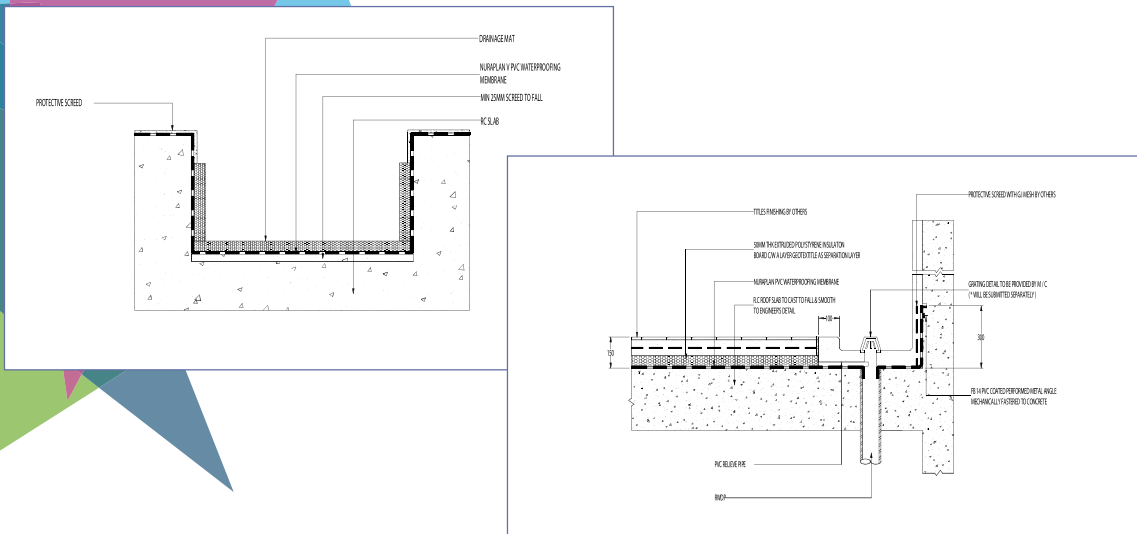

## SPECIAL FEATURES

### High Durability

Nuraplan V is UV-resistant and root resistant.

### Flexible and Tough

Membrane is flexible to withstand thermal and other movements within the substrate yet has high tensile and tear strength

### Compatible with Bitumen

Can be applied on all standard bituminous layers and insulation materials including rigid polystyrene foam boards

### High Vapour Permeability

Allows moisture in substrate to escape from the roof all over the membrane surface

### Welded Joints

Seam between 2 different rolls are hot-air welded. This are superior to seams welded using adhesives.

### Non-Slip

Its non-slip surface eliminates the danger of fall when surface is wet

### WARRANTY INFORMATION

Only Hitchins' trained applicators are approved to undertake all application work. Hitchins products carry a long-term warranty for both materials and workmanship. The warranty is further backed by Hitchins International Fidelity Fund. Please check with our local applicators if this fund is available in your country. For complete warranty and other related information, please contact Hitchins regional offices.



ASIA'S LEADING  
BUILDING PROTECTION  
SPECIALIST

# NURAPLAN V

PVC WATERPROOFING MEMBRANE FOR ROOFS

## DATA SPECIFICATION SHEET



032 002  
Environmentally  
Preferred Coating

### DESCRIPTION

Nuraplan V is a high quality single ply polymeric PVC waterproofing membrane for used on roofs, decks and landscape gardens. It is a strong, tough PVC membrane with excellent physical properties designed for both exposed and concealed waterproofing application. The membrane is tested for root resistant with excellent weathering properties.

Nuraplan V is available in either unbacked or with polyester fleece backing. The membrane can be installed either loosely laid, fully adhered or mechanically fastened to the substrate.

Nuraplan V is available in the following thickness

Unbacked membrane : 1.2mm, 1.5mm & 2.0mm

Polyester Fleece backing: 2.2mm, 2.5mm & 3.0mm

### AREAS OF USAGE

Nuraplan V can be installed either as an exposed or concealed waterproofing membrane for roofs, decks, patios, gutters, roof gardens, basement and tunnels. It can be installed on substrate such as concrete, sound light-weight concrete, plywood etc.

### PRODUCT SPECIFICATION

**FIRE RESISTANCE (DIN 4102-1):** Class B2

**TENSILE STRENGTH / ELONGATION AT BREAK (DIN 53455):** 17.6N/mm<sup>2</sup> / 483%

**BRITISH BOARD OF AGREEMENT (BBA):** ≥25 years

**DIMENSIONAL STABILITY (EN 1107-2):** 0.08% (Longitudinal)/ 0.12% (Transverse)

**UV EXPOSURE (1000HRS) (BS EN 1297):** No Blistering, No Cracking, No Chalking, No Peeling & No Delamination

**WATER VAPOUR TRANSMISSION (BS EN 1931):** 0.09 g/m<sup>2</sup>/hour

**MOISTURE RESISTANCE FACTOR (DIN 16726):** 10629 μ

**RESISTANCE AGAINST ROOT PENETRATION (FLL 1984):** Passed

**PLIABILITY (SS374:1994):** No Surface Rupture or Crack Observed

**PEEL RESISTANCE AT JOINTS (BS EN 12316):** Break outside of Joints

**PERFORATION RESISTANCE (DIN 16726):** Passed at 300mm

**BITUMEN COMPATIBILITY (DIN 16726):** Average Change of Young's Modulus, ≤ -13.72%

**PUNCTURE RESISTANCE (SIA 280) :** 990mm Average Drop Height

**RESISTANCE TO HYDROSTATIC PRESSURE - 7 BARS (BS EN 1928) :** No Rupture / Leakage

**WATER TOXICITY (SS 375) :** Deem Suitable for Use in Contact with Water Intended for Human Consumption

## SUBSTRATE PREPARATION

Make sure the substrate is smooth, clean and free of dirt, oil etc. Provide angle fillet at all upturn areas to parapet.

## APPLICATION

### Equipment for Installation

Tools necessary to lay Nuraplan V waterproofing membrane shall include scissors, blade cutter, pressure roller and hot air welding tools.

### Installation Procedure

- a) Unroll Nuraplan V membrane
- b) The effective heat welded lap between two rolls shall be minimum 50mm width
- c) Membrane to terminate minimum 150mm above finished floor level

### Adhesives for fully adhered system

- Nuraplan V (unbacked) – fast drying contact adhesive such as Tiger brand, World brand or its equivalent is recommended
- Nuraplan V (polyester fleece backing) – use Nuraplan AD adhesive or approved adhesives

### RECTIFICATION TO DAMAGED MEMBRANE

Should there be minor puncture on the installed membrane. Cut a new piece of membrane size 100 x 100mm and place over the punctured area. Seal by hot air welding.

### WATER PONDING

The waterproofed areas shall be tested for water-tightness by ponding either entirely or in sections for minimum 24 hours.

## HEALTH & SAFETY

Read the product label and Material Safety Data Sheet (MSDS) before use. Users should acquaint themselves with all risk and safety phrases.

Hitchins (FE) Marketing Pte Ltd  
Telephone: (65) 6861 1177  
Facsimile: (65) 6863 4240  
Email: [hitchins@hitchins.com](mailto:hitchins@hitchins.com)

Place Product  
Sample Here

Revision B - Jun 21

All data given and statements and recommendations made herein are base upon our research and experience and are believed to be accurate. However, no guarantee of their accuracy is made or applied. This data specification supersedes all other issues.

# MAJOR PROJECTS



Audi Centre - Singapore



Changi General Hospital - Singapore



United World College (S.E.A.) - Singapore



Green Belt 5 - Manila Philippines



HSBC - Nuraplan - HongKong



Metropolis @ One North - Singapore



Singapore University of Technology Design



Vichayut Hospital - Bangkok Thailand



Verticas Residences - Kuala Lumpur

# APPLICATION & INSTALLATION



1. Surface Preparation



2. Contact Adhesive Applied



3. Hot Air Machine to Weld Joints



4. Pipe Penetration Detail



5. Upturn Detail



6. Complete Installation